



\* G 0 0 0 0 0 0 1 \*

Version 18.3

Preservation version

Please read this first

# Internet setup guide

STEP 1



Let's prepare  
the things you need!

STEP 2



Let's connect  
the device(s)!

STEP 3



Let's set up  
the Internet connection!

In 3 steps  
Easy setup!



You can check the information on our website or in videos.



<https://www.ntt-west.co.jp/collabo/rd/sgco/>

English · Português · 中文 · 한국어



<https://flets-w.com/rd/sgco/>



In case of an  
emergency

The information you include here is important personal information. Please keep this memo in a safe place and take care to avoid the loss or leak of your information.

Information on  
home gateway\*

User name for  
device setup

Password for  
device setup

※This can be a string of any characters that are input when setting up the home gateway in STEP 3.

# Introduction

"Thank you very much for signing up for the Internet connection service.

This guide shows how to connect and set up the Internet. Please connect the device(s) and set up by checking each step."

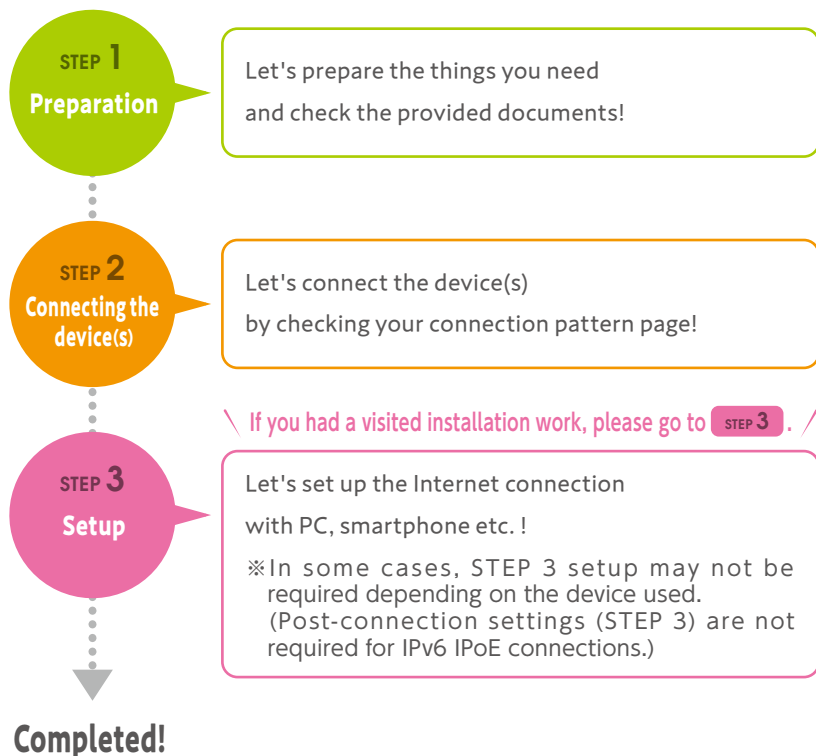

- The instructions on this guide are on the premise that only the devices with NTT logo(☎) are used.
- If you use a device other than the one with NTT logo, please refer to its instruction manual first.



STEP 1

# Preparation

Please prepare the following items by the installation date.

Things you need to prepare

Required for

STEP 2



☒ PC

※LAN port is required



☒ LAN cable



☒ Telephone set



☒ Telephone cord

(Telephone set and telephone cord are required only for telephone user)

Document sent by a Hikari collaboration company or NTT WEST, and document sent by your contracted ISP

Required for

STEP 3

☒ お申し込み内容のご案内(Service application confirmation) (image)

■ ご利用開始情報	
工事予定日	0000年 0月0日
■ ご利用開始情報	
お客さまID	CAF0123456789
アクセスキー (アクセスパスワード)	aBsD1234

Please connect the device(s) according to the scheduled installation date.

For setup "お客さまID(Customer ID)" and "アクセスキー(Access key)" may be required.

Notification methods of "お客様ID(Customer ID)" "アクセスキー(Access key)" etc. vary depending on the company. Customers who signed up for the service provided by a Hikari collaboration company, please contact your Hikari collaboration company. Customers who signed up for NTT WEST FLET'S Hikari, please contact NTT WEST.

☒ Internet Service Provider(ISP) information (image)

Notified by the ISP at the time of signing the contract

■ インターネット接続	
プロバイダー名	ABCプロバイダー
接続アカウント	taro@xxx.ne.jp
接続パスワード	lmnopq

Examples of a connection account

- 認証 ID (Authentication ID)
- ログイン ID (Login ID)
- (ISP's name) ID
- ユーザー ID (User ID)
- 接続 ID (Connection ID)
- 接続ユーザー名 (Connection user name) etc. (e.g.) taro@xxx.ne.jp

Examples of a connection password

- 認証パスワード (Authentication password)
- 接続パスワード (Connection password)
- ネットワークパスワード (Network password) etc.
- パスワード (Password)
- ログインパスワード (Login password)

※ Account information name varies by ISP.

ISP's contract is required to be connected to the Internet. Even if you already have an ISP contract, you may need to change the contract when you change your fiber-optic access service. If you have any questions, please contact your contracted ISP company.

STEP 2

# Confirm your connection pattern

Please confirm your connection pattern with the NTT WEST device(s) and your applied service(s) first, then proceed to the corresponding page.

Diagrams and instructions on the pages that follow and connection patterns are typical examples of using NTT WEST device(s). Please check the instruction manual of your device for the details(including how to check completion of the connection such as lamp status etc.)

If you applied for a Home Gateway as an optional service, it will be sent separately.

Home Gateway

Wireless LAN card

Family Fiber-Optic Cable type

Mansion Fiber-Optic Cable type

▶ Customers who applied only for Internet

Pattern A

P.05-P.06 (upper part)

ONU Fiber-optic cord Power adapter

▶ Customers who applied for telephone and Internet

Pattern B

P.05-P.06 (lower part)

Home Gateway (with ONU function) Fiber-optic cord Power adapter

▶ Customers who applied for Small ONU

Pattern C

P.07-P.08

Home Gateway Fiber-optic cord Power adapter Small ONU

▶ Customers who applied for the service with approximate maximum communication speed of 10 Gbps

<https://www.ntt-west.co.jp/collabo/rd/cro/>

There are different types of fiber optic sockets as follows. Please check before you proceed to the connection step!

How to open the connection port varies depending on the type of fiber-optic socket.

No-cover type

Do not look into the fiber-optic connection port!

Covered type

Mansion VDSL Cable Type

▶ Customers who applied only for Internet

Pattern D

P.09-P.10 (upper part)

VDSL modem Telephone cord Power adapter

▶ Customers who applied for telephone and Internet

Pattern E

P.09-P.10 (lower part)

VDSL modem Telephone cord Power adapter Home Gateway LAN cable Power adapter

03

04



## Pattern A

### 1 Confirm the device connection time

Please connect the device **between 8:00~22:00** on the installation date.

(If you connect the device after 22:00, the service will start from 8:00 on the following day.)

! Please see P.03-P.04 for fiber-optic sockets.

2 kinds of cables will be used!

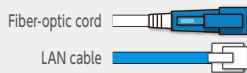

Fiber-optic socket

### 2 Connect the fiber-optic cord

Fiber-optic cord

Remove the lid

### How to handle Fiber-optic cords

Plug the fiber-optic cord firmly to the fiber-optic socket and to the Small ONU.

When it is plugged properly, ☐ part will be in blue.

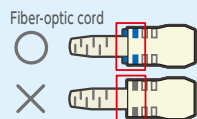

※ The shape may vary.

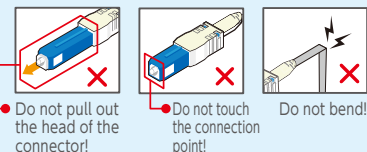

! Do not unplug the power cord or the LAN cable until the lamp status indicates as described at 5. about 30 minutes

### 4 Turn the power on

### 3 Connect your PC

LAN cable

If you use an optional Home Gateway, please connect it between the ONU and the PC!

### How to handle an ONU

While pressing onto the ☐ part, open the lid to the direction as the arrow indicates.

Remove the cap and insert the fiber-optic cord.

4 must not be done before 2!

Power outlet

### 5 Confirm the connection

Check the ONU lamp status to make sure it is connected properly.

ONU

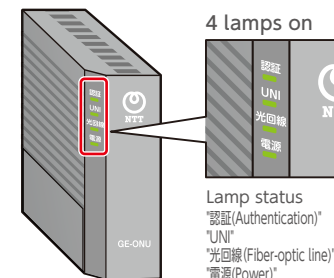

Go to P.11 for STEP3 Internet connection setup



## Pattern B

### 1 Confirm the device connection time

Customers who transferred their telephone number such as analog line to Hikari Denwa(Fiber-optic telephone)

Please connect the device **between 8:00~12:00** on the installation date.

(If you connect the device before 8:00, the service will start from 8:00. Note: In case you connect the device after 12:00, the service will not be able to start on the same date, and the activation date may need to be rescheduled and delayed by a few days.)

Customers who use Hikari Denwa (Fiber-optic telephone) with a dedicated fiber-optic telephone number.

Please connect the device **between 8:00~22:00** on the installation date.

(If you connect the device after 22:00, the service will start from 8:00 on the following day.)

3 kinds of cables will be used!

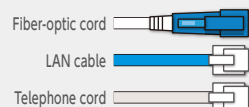

Fiber-optic socket

### 2 Connect the fiber-optic cord

Fiber-optic cord

Remove the lid

! Please see P.3-P.4 for fiber-optic sockets.

### How to handle a Home Gateway

While pressing onto the ☐ part, open the lid to the direction as the arrow indicates.

Remove the cap and insert the fiber-optic cord.

5 must not be done before 2!

! Do not unplug the power cord or the LAN cable until the lamp status indicates as described at 6. about 30 minutes

### 3 Connect your PC

LAN cable

### 4 Connect your telephone set

Telephone cord

### 5 Turn the power on

### 6 Confirm the connection

Check the Home Gateway lamp status to make sure it is connected properly.

Home Gateway

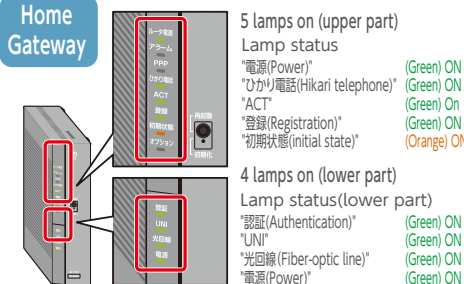

Customers who transferred their telephone number such as analog line to Hikari Denwa(Fiber-optic telephone)

If you make a call from a mobile phone etc. to the installed telephone and a ringtone sounds, the transfer of the phone number is also completed!

Go to P.11 for STEP3 Internet connection setup



## Pattern C

### 1 Confirm the device connection time

Customers who use only Internet or who use Hikari Denwa(Fiber-optic telephone) with a dedicated fiber-optic telephone number

Please connect the device **between 8:00~22:00** on the installation date.

(If you connect the device after 22:00, the service will start from 8:00 on the following day.)

Customers who transferred their telephone number such as analog line to Hikari Denwa (Fiber-optic telephone)

Please connect the device **between 8:00~12:00** on the installation date.

(If you connect the device before 8:00, the service will start from 8:00. Note: In case you connect the device after 12:00, the service will not be able to start on the same date, and the activation date may need to be rescheduled and delayed by a few days.)

3 kinds of cables will be used!

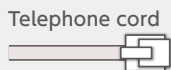
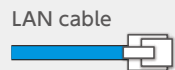

※ telephone user only

### 2 Insert Small ONU

Small ONU

Face the side with ▲ mark right side!



Home Gateway

Cap

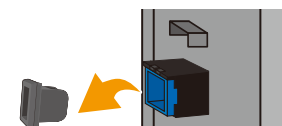

Remove the cap from the inserted Small ONU

### 3 Connect the fiber-optic cord

Plug the fiber-optic cord firmly to the fiber-optic socket and to the Small ONU.

Fiber-optic cord

When it is plugged properly,   part will be in blue.

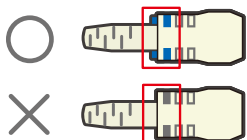

※The shape may vary.



Fiber-optic cord precautions for use

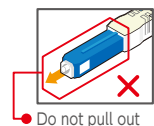

Do not pull out the head of the connector!

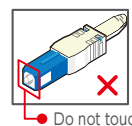

Do not touch the connection point!

Do not bend!

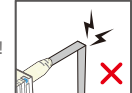

Please see P.03-P.04 for fiber-optic sockets.

Fiber-optic socket

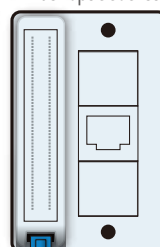

Fiber-optic cord

Home Gateway

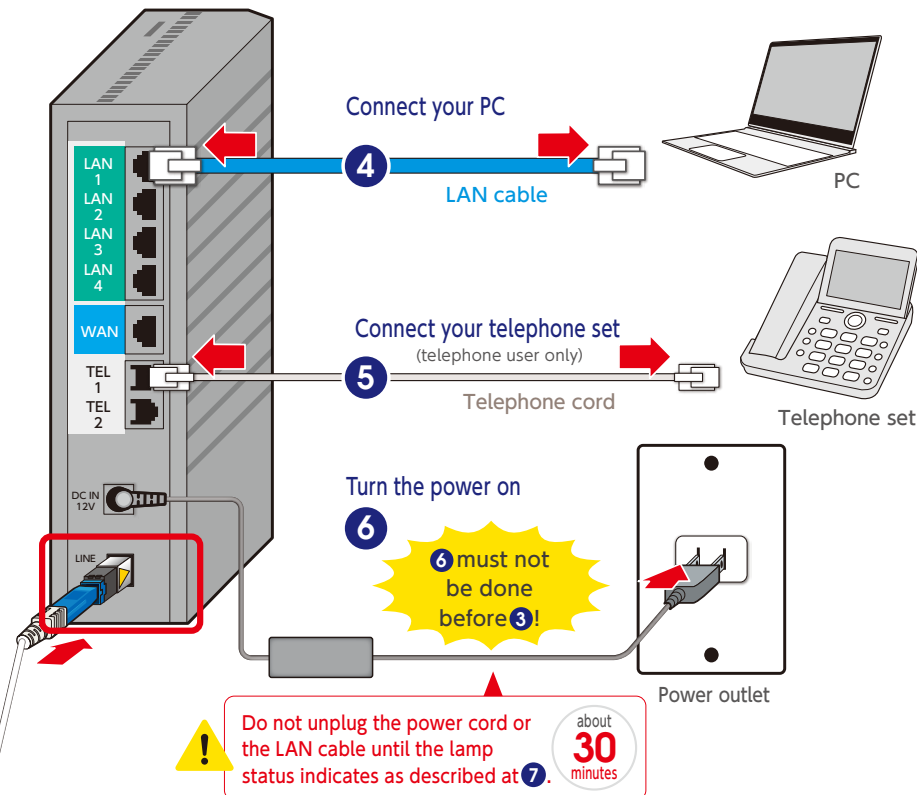

### 7 Confirm the connection

Check the Home Gateway lamp status to make sure it is connected properly.

Home Gateway (Front)

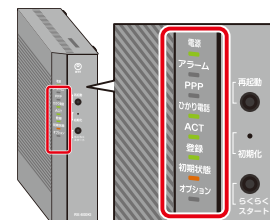

5 lamps on (upper part)

Lamp status

"電源(Power)" (Green) ON  
"ひかり電話(Hikari telephone)" (Green) ON  
"ACT" (Green) ON  
"登録(Registration)" (Green) ON  
"初期状態(initial state)" (Orange) ON

Home Gateway (Back)

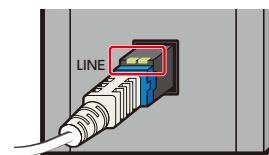

2 lamps on the Small ONU

(Green) ON/ Flashing

※ The device image is only an example. Shape or color of Small ONU compatible device may vary.

Customers who transferred their telephone number such as analog line to Hikari Denwa(Fiber-optic telephone)  
If you make a call from a mobile phone etc. to the installed telephone and a ringtone sounds, the transfer of the phone number is also completed!

Go to P.11 for STEP3 Internet connection setup

## Pattern D

- 1** Confirm the device connection time  
Please connect the device on the installation date.

Modular jack

Connect the telephone cord

Telephone cord

VDSL modem

2 kinds of cables will be used!

LAN cable

Telephone cord

PC

LAN cable

**3** Connect your PC

Power outlet

Turn the power on

**4** must not be done before **2**!

! Do not unplug any cords or cables until the lamp status indicates as described at **5**.

about 30 minutes

- 5** Confirm the connection

Check the lamp status to make sure it is connected properly.



VDSL modem

3 lamps on

Lamp status

"POWER"

(Green) ON

"LINE or VDSL LINK"

(Green) ON

"LINK/ACT or LAN LINK"

(Green) ON

Go to P.11 for STEP3 Internet connection setup

## Pattern E

- 1** Confirm the device connection time  
Please connect the devices on the installation date.

VDSL modem

**2** Connect the telephone cord

Modular jack

! Please use the provided LAN cable.

**3** Connect the LAN cable

Home Gateway

2 kinds of cables will be used!

LAN cable

Telephone cord

LAN cable

Telephone cord

Turn the power on

**7** must not be done before **6**!

Power outlet

Turn the power on

**4** Connect your PC

PC

**5** Connect your telephone set

Telephone set

- 8** Confirm the connection

Check the lamp status to make sure it is connected properly.



VDSL modem

3 lamps on

Lamp status

"POWER"

(Green) ON

"LINE or VDSL LINK"

(Green) ON

"LINK/ACT or LAN LINK"

(Green) ON



Home Gateway

4 lamps on

Lamp status

"電源(Power)"

(Green) ON

"ひかり電話(Hikari telephone)"

(Green) ON

"ACT"

(Green) ON

"登録(Registration)"

(Green) ON

Go to P.11 for STEP3 Internet connection setup





## STEP 3

# Setup

Please go to the setup page corresponding to your device(s) and your usage environment.



### PC setup

Setup using the Simple Setup Tool with a **Windows PC** (Recommended)

P.12

Setup without using the Simple Setup Tool with a **Windows PC**

If you use a **Home Gateway**

P.13~P.14

If you use an **ONU**

P.15~P.16

For the setup with **Mac OS**, please see here



### Setup the Internet connection with a smartphone or tablet

Setup with **Android OS**

P.17

Setup with **iOS(iPhone etc.)**

P.18

If you applied for the service with approximate maximum communication speed of 10 Gbps and set up the Internet connection, please see here



## STEP 3 (Windows) Setup using the Simple Setup Tool

Video is available here ▶



### 1 Open "Microsoft Edge" and type in the following URL

<https://www.flets-west.jp/set/> ※ In case you can not access the page even with the correct URL, go to "Setup without using The Simple Setup Tool" section on P13 or P15.

### 2 Select and download (the Simple Setup Tool)

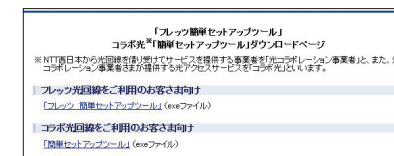

### 3 Double-click the downloaded file and 「実行(run)」

#### System requirements for the Simple Setup Tool

Operating OS	Windows 11, Windows 10 ※compatible only with Japanese version OS	HDD space	1.3GB or more (1.5GB or more recommended) HDD space ※ Compatible with RAID-0/RAID-1. Other RAID levels are not compatible.
CPU	1GHz or higher recommended	Display	High resolution display adapter with Super VGA(800x600) or more and 16 bit(65536 colors) or more
Memory	[32bit ver.] 1GB or more recommended [64bit ver.] 2GB or more recommended	Compatible browser	Microsoft Edge, Google Chrome
Ethernet adapter	Microsoft compatible NDIS6.0		

※ Even on the confirmed environment as mentioned on the left, the tool may not operate properly depending on the customer's device used, the connection status of the device, etc.

※ By using this tool, Home Gateway setting or PC's IP address/Proxy setting may be changed. (If you want to avoid such setting changes, please refrain from using this tool.)

※ You may not be able to set up various applications due to our company's facility maintenance etc.

※ While the Hikari Denwa(Fiber-optic telephone) is in use, please refrain from doing the setup.

※ As important screens of the set up are mainly shown, some screens are not described in this manual. Please proceed the setup by following the instructions on the screen.

### 4 Password setup for Home Gateway

(This page will be displayed only when you use a Home Gateway.)

Set your own password of your choice and type it into the boxes. Then click [次へ(next)].

Please take a note of your password and keep it safe.

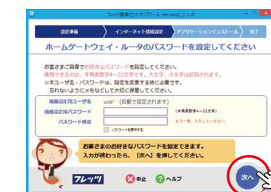

### 5 Internet connection setup

Enter "the connection account" and "the connection password" provided by the ISP and then click [次へ(next)].



インターネット接続	
プロバイダー名	ABCプロバイダー
接続アカウント	taro@xxx.ne.jp
接続パスワード	lmnopq

※Account information name varies by ISP.

Examples of a connection account

- 認証 ID (Authentication ID)
- ログイン ID (Login ID)
- (ISP's name) ID
- ユーザー ID (User ID)
- 接続 ID (Connection ID)
- 接続ユーザー名 (Connection user name) etc.

(e.g.) taro@xxx.ne.jp

Examples of a connection password

- 認証パスワード (Authentication password)
- パスワード (Password)
- 接続パスワード (Connection password)
- ログインパスワード (Login password)
- ネットワークパスワード (Network password) etc.



## 1 Preparation If you use the Internet with a cable, please go to 3.

1 First turn off the Home Gateway and then insert the Wireless LAN card(option) on the top of the Home Gateway. Then turn on the Home Gateway.

2 Confirm SSID/暗号化キー(Wi-Fi password)

SSID and 暗号化キー(Wi-Fi password) are displayed on the label attached to the side of Home Gateway.

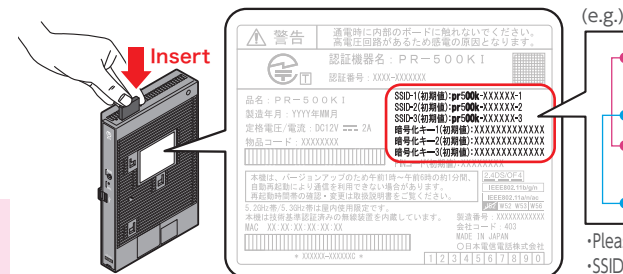

(e.g.)

- SSID-1 (初期値) : pr500k-XXXXXX-1
- SSID-2 (初期値) : pr500k-XXXXXX-2
- SSID-3 (初期値) : pr500k-XXXXXX-3
- 暗号化キー-1 (初期値) : XXXXXXXXXXXXX
- 暗号化キー-2 (初期値) : XXXXXXXXXXXXX
- 暗号化キー-3 (初期値) : XXXXXXXXXXXXX

• Please use SSID1 or SSID3.

• SSID and 暗号化キー(Wi-Fi password) are the combinations of half-width alphanumeric characters specific to the product.

## 2 Wi-Fi device (extension) connection setup

1 Click the Network icon at the right bottom side of the screen and then click

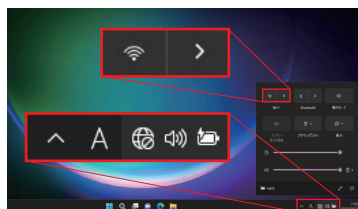

2 From the displayed SSID list, please click the one that corresponds to SSID1 or SSID3 written on the Home Gateway label and click connect.

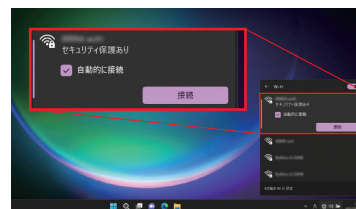

3 Type in "暗号化キー (Wi-Fi password)" corresponds to the SSID. Proceed to the next step by following the screen instruction.

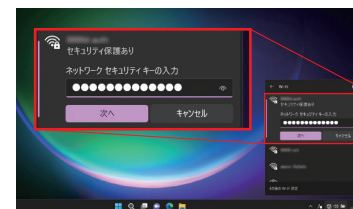

4 WiFi setup is completed when "Connected" is displayed.

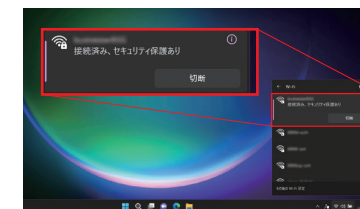

## 3 Home Gateway setup

1 Open "Microsoft Edge" and type in 192.168.1.1

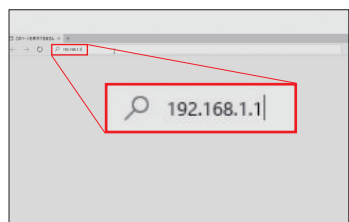

2 Type and set a password of your choice and enter the same password on the next page.

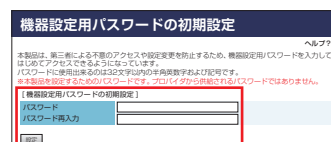

Please take a note of your password and keep it safe.

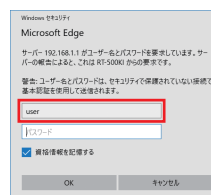

For ユーザー名(user name), type in user. For パスワード(password), please type in the password you just set on the left screen.

3 Enter the ISP information. (See P.02)

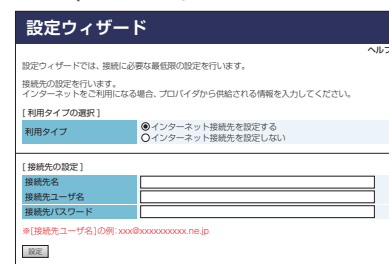

4 When the PPP lamp on the Home Gateway lights in green or orange, the setup is completed.

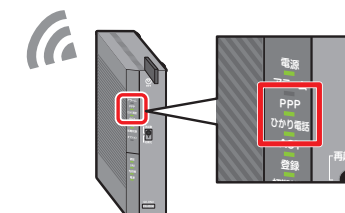





※The following method is an example using Windows 11. Screen display may vary depending on the environment of your device.

1

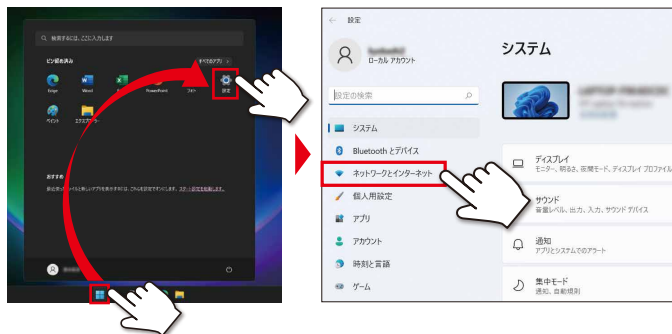

Open the Windows settings page

Click [Start]

スタート

[Settings]

設定

[Network and Internet]

ネットワークとインターネット

If you use Windows 10 | Click [Start]→[Settings]→[Network and Internet]

2



Open the new settings page

Click [Dial-up]

ダイヤルアップ

[Set up a new connection]

新しい接続を設定する

If you use Windows 10 | Click [Dial-up]→[Set up a new connection] on the new settings screen

3

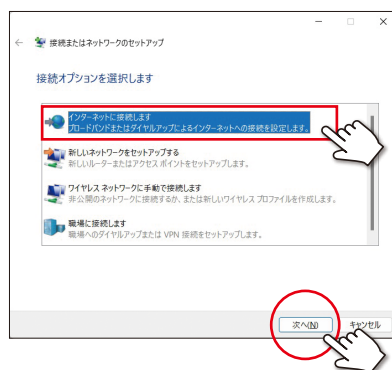

After selecting "Connect to the Internet"

インターネットに接続します

click [Next]

次へ

4

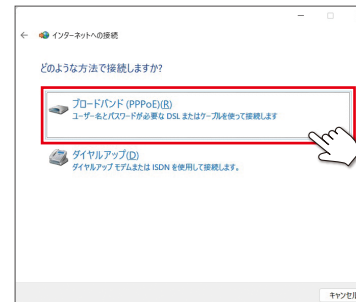

Click [Broadband (PPPoE)] | ブロードバンド(PPPoE)

※Depending on your device environment, the following screen may appear. Give a check to "No, create a new connection" and click [Next]

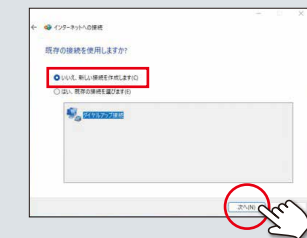

5



Enter your ISP information and then click [Connect]

接続

[User name]

ユーザー名 | Connection account

[Password]

パスワード | Connection password

[Remember this password]

このパスワードを記憶する | check

[Connection name]

接続名 | Set a name of your choice (ISP's name etc.)

※Regarding the ISP information, please refer to P.2

6

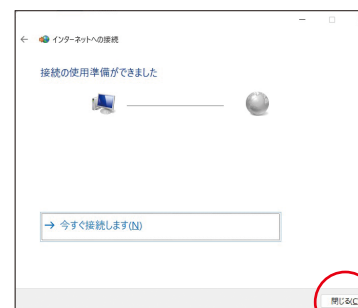

When you can confirm the Internet connection on the Internet connection screen, then click [Close]. | 閉じる

※In case you are not connected to the Internet automatically when opening the browser, select the icon shown on the right on the taskbar then select the connection name that you set at 5 and then click [Connect].

Windows11 taskbar and icons



※Windows10 icons

Go to P.17 for Internet connection setup with a smartphone or tablet



※This is a setup method using Home Gateway and Wireless LAN card.

## 1 Preparation If you have already finished P.13-P.14, please go to 2.

- First turn off the Home Gateway and then insert the Wireless LAN card(option) on the top of the Home Gateway. Then turn on the Home Gateway.
- Confirm SSID/暗号化キー(Wi-Fi password)

SSID and 暗号化キー(Wi-Fi password) are displayed on the label attached to the side of Home Gateway.

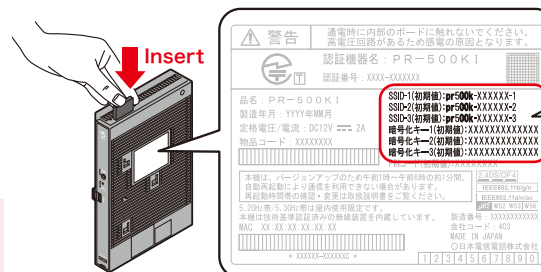

- (e.g.)
- SSID-1 (初期値): pr500k-XXXXXX-1
  - SSID-2 (初期値): pr500k-XXXXXX-2
  - SSID-3 (初期値): pr500k-XXXXXX-3
  - 暗号化キー-1 (初期値): XXXXXXXXXXXXX
  - 暗号化キー-2 (初期値): XXXXXXXXXXXXX
  - 暗号化キー-3 (初期値): XXXXXXXXXXXXX

•Please use SSID1 or SSID3.  
•SSID and 暗号化キー(Wi-Fi password) are the combinations of half-width alphanumeric characters specific to the product.

### Android OS

## 2 Wi-Fi device (extension) connection setup

※ This is only an example. If you have any questions regarding the operation of your device, please contact the manufacturer of the device.

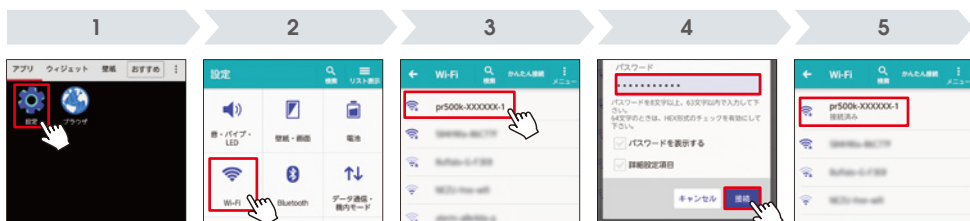

1 Tap on [Settings icon] on the Home screen.  
2 Tap on [Wi-Fi] and turn it on.  
3 Select the SSID that you confirmed at 1.  
4 Enter the 暗号化キー that you confirmed at 1 and then tap on [Connect].  
5 Check the connection.

### iOS (iPhone etc.)

## 2 Wi-Fi device (extension) connection setup

※ This is only an example. If you have any questions regarding the operation of your device, please contact the manufacturer of the device.

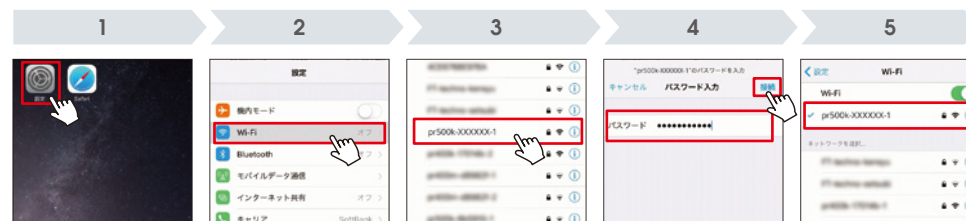

1 Tap on [Settings icon] on the Home screen.  
2 Tap on [Wi-Fi] and turn it on.  
3 Select the SSID that you confirmed at 1.  
4 Enter the 暗号化キー that you confirmed at 1 and then tap on [Join].  
5 Check the connection.

## 3 Home Gateway setup If you have already finished P.13.-P.14 setup, this process is not required.

- Use the following QR code or enter 192.168.1.1 on the Internet browser.
- Type and set a password of your choice and enter the same password on the next page.

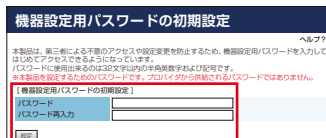

Please take a note of your password and keep it safe.

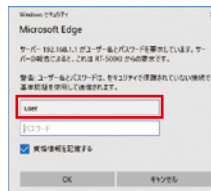

For ユーザー名(user name), type in user. For パスワード(password), please type in the password you just set on the left screen.

- Enter the ISP information.(See P.02)

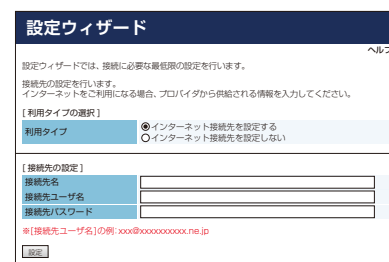

- When the PPP lamp on the Home Gateway lights in green or orange, the setup is completed.

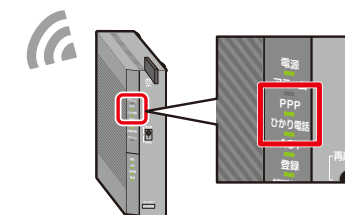

## FAQs

### About STEP2 (connecting devices)

- Q1.** I connected the device(s), but the NTT device lamp doesn't indicate the status described as "connection completed". **A1.** Did you connect the device(s) on the date of installation?  
Please check the installation date(see STEP1)and the device connection or replacement time(see STEP2) notified by your contracted Hikari collaboration company.  
・If the device was connected before the installation date: Please reconnect it on the installation date or later.  
・If the device was connected on the installation date or later: Please try rebooting(unplug and plug the power cable ) the NTT device.
- Q2.** I would like to connect a different company's router. **A2.** Please connect the different company's router with a LAN cable to a "LAN port" or the "UNI port " of the NTT device.  
When you connect a specific device provided by the Hikari collaboration company, please refer to the instruction manual of the device.

### About STEP3 (Internet connection setup)

- Q3.** I can't download the latest version of "the Simple Setup Tool" **A3.** Device connection STEP2(connecting devices) may not be completed correctly.  
Please check the wiring and the lamp status again. You may not be able to download this tool, if you use a different company's router or a device provided by the Hikari collaboration company. Please see the "Setup without using the Simple Setup Tool" on P.13-P.16 to check the Internet setup method without using this tool.
- Q4.** I want to connect Wi-Fi with my PC. **A4.** Preparation and setup of a Wi-Fi device is required.  
Please set up by following the instruction manual of your terminals and devices. Setup method is also available on the website written on the cover.
- Q5.** I want to install "セキュリティ対策ツール(Security software)". **A5.** It is provided as a basic function for "FLET'S Hikari"(FTTH access service) users and users of some "Collabo Hikari" .  
For installation and setup method, please check here ▶▶▶ <https://www.ntt-west.co.jp/collabo/rd/sec/>



### Inquiries

Customers who signed up for the service provided by a Hikari collaboration company, please contact your Hikari collaboration company. Customers who signed up for NTT WEST FLET'S Hikari, please contact the number written on "お申し込み内容のご案内(Service application confirmation)".



### Precautions regarding this guide

#### ●Copyright/Disclaimer

- ・ Copying or revising this guide, in whole or in part, is prohibited without the permission of NIPPON TELEGRAPH AND TELEPHONE WEST CORPORATION. Unauthorized copying and so forth are prohibited by law.
- ・ The contents of this guide are subject to change without notice.
- ・ Product descriptions on this guide are provided for informational purposes and are not warranted or recommended.
- ・ Regarding software and data, NIPPON TELEGRAPH AND TELEPHONE WEST CORPORATION disclaims all warranties including operation guarantee. NIPPON TELEGRAPH AND TELEPHONE WEST CORPORATION shall not be responsible for any interferences caused by using software and data and shall make no compensation for damages; provided, however, that this shall not apply to the cases attributable to our company and the cases of latent defect.
- ・ Product names, company names and service names shown here are each company's registered trademarks and trademarks.
- ・ TM symbol and ® symbol are not displayed in the text.
- ・ Displays on this guide are for illustrative purposes and actual displays can be different depending on your device environment.

Date of issue: March 2024

※The contents of this guide are based on information as of March 2024. Screen images and contents are subject to change. Please check the following website for the latest information.

<https://www.ntt-west.co.jp/collabo/rd/sgco/>